

Aston

Completamente sfoderabile
Totally removable cover
Complètement déhoussable

Dimensioni / Dimensions

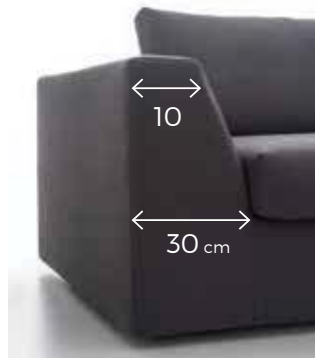
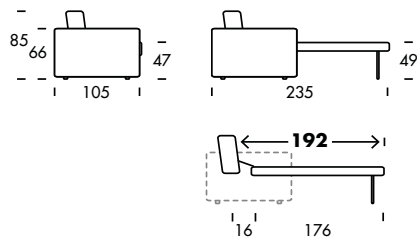

New!

Facile apertura nuovo
telaietto porta guanciaie.
Rivestito con lo stesso
tessuto del materasso.

Easy-opening new pillow
holder frame. Covered
in the same fabric as the
mattress.

Ouverture facile du
nouveau coffre de
rangement oreillers.
Revêtu avec le même
tissu du matelas.



Caratteristiche tecniche

Struttura - Realizzata con masselli portanti in legno massiccio di abete in vari spessori. Fianchi e parti strutturali in multistrato di abete da 18 mm, parti di tamponamento in agglomerato di legno di spessore 18mm e 4 mm. Il tutto trattato al naturale in classe E1, pertanto a bassa emissione di formaldeide. Il telaio è completamente rivestito con vellutino 100% poliammine termo accoppiato ad espanso 100% poliuretano e/o ovatta resinata da 200 gr di 100% poliestere.

Imbottitura - Cuscino seduta in poliuretano espanso flessibile e indeformabile in densità 30MS rivestito in falda termolegata da 300 gr in fiocco di poliestere 100%. Bracciolo e parti di tamponamento in lastre di poliuretano indeformabile in 26NY. Composizione cuscino schiena e bracciolo 50% piuma d'oca e 50% espanso bianco contenuti in una fodera composta al 35% in cotone e 65% poliestere. **I materiali corrispondono alle normative europee 91/156/etc. Informazioni ambientali sulla sicurezza:** la deperibilità del prodotto, secondo la sua composizione, è praticamente nulla. Le resine non sono contenute nella lista della normativa di classificazione dei rifiuti per materiali soggetti a particolare sorveglianza. Le resine espanso sono esenti da freon e solventi clorurati. Le resine espanso non contengono sostanze che danneggiano l'ozonofera e non vengono fabbricate con prodotti menzionati nel protocollo di Montreal e Regolamento (CE) n. 3093/94.

Piedini - Piedini in abs nero.

Molleggio - Il molleggio è realizzato in nastri da 80 mm tesi meccanicamente, composta da fili di nylon avvolto a spirale.

Meccanismo rete da inserimento con apertura a due pieghe dal minimo ingombro. Telaio in tubo da mobilio ad alta resistenza con verniciatura epossidica: Fornito di piano cuscino che rende il piano dormita più lungo di 16 cm. Piano dormita con rete elettrosaldata e cinghie elastiche terminali.

Materasso in espanso D25 indeformabile rivestito in tessuto stretch trapuntato in poliestere 100% h 11 cm.

Technical characteristics

Structure - Made with bearing parts in solid fir wood in various thicknesses. 18mm fir plywood sides and structural parts, 18mm and 4 mm thick particle wood infill parts. All treated naturally in Class E1, thus with low formaldehyde emissions. The frame is completely covered with 100% polyamines velvetene thermo-coupled with 100% polyether foam and/or 200 g. 100% polyester wadding resin.

Padding - Flexible and non-deformable polyurethane foam seat cushion, density 30MS, coated with 300 gr layer-bonded 100% polyester staple.

Armrest and structural parts made of 26NY polyurethane foam sheets. Pillow, backrest and armrest set: 50% goose down and 50% white foam in a 35% cotton and 65% polyester slip cover. **The materials meet the European standards 91/156/etc. Environmental information on safety:** The perishable nature of the product, according to its composition, is practically nil. Resins are not included in the list of standards for the classification of waste materials subject to special surveillance. Resin foams are free from freon and chlorinated solvents. Resin foams do not contain substances that damage the ozone layer and are not manufactured with products mentioned in the Montreal Protocol and (CE) Regulation no. 3093/94.

Feet - Feet in black abs.

Springs - springs are made from 80 mm mechanically tensioned bands in spirally wound nylon wires.

Mechanism for insertion with double fold, compact opening. Frame in high resistance, epoxy-painted furniture piping: coming with pillow support which increases the sleeping surface by 16 cm. Electro-welded sleeping base net with elastic belts.

Mattress in D25 shape-retaining foam rubber, covered in 100% polyester quilted stretch fabric, h 11 cm.

Caractéristiques techniques

Structure - Réalisée avec des éléments porteurs en bois massif de sapin de différentes épaisseurs. Panneaux latéraux et éléments structuraux en bois de sapin stratifié de 18 mm, élément de remplissage en agglomérat de bois de 18 mm et 4 mm. Le tout traité au naturel en classe E1, soit à faible émission de formaldéhydes. Le cadre est entièrement recouvert de velours 100% polyamines couplé à chaud à 100% de résine expansée 100% polyéther et/ou ouate de 200 g 100% polyester.

Rembourrage - Coussin d'assise en mousse de polyuréthane souple et indéformable densité 30MS revêtu en couche collée de 300 g en flocons 100% polyester. Accouder et éléments de remplissage en plaques de polyuréthane indéformable en 26NY. Composition coussin dossier et accouder 50% plume d'oie et 50% mousse blanche dans une housse composée de 35% coton et de 65% polyester. **Les matériaux sont conformes aux normes européennes 91/156/etc. Informations environnementales sur la protection:** la nature périssable du produit, sur la base de sa composition, est pratiquement nulle. Les résines ne figurent pas dans la liste établie par la norme de classification des déchets de matériaux soumis à une surveillance particulière. Les résines expansées ne contiennent pas de fréon ni de solvants chlorés. Les résines expansées ne contiennent pas de substances nuisibles à la couche d'ozone et ne sont pas fabriquées avec des produits figurant dans le Protocole de Montréal et le Règlement (CE) n° 3093/94.

Pieds - Pieds en abs noir

Suspension - La suspension est réalisée avec des sangles de 80 mm tendues mécaniquement, composées de fils en nylon enroulé en spirale.

Mécanisme à insertion avec ouverture à deux plis pour un encombrement minimum. Cadre en tube d'acier à haute résistance avec vernis époxy. Avec plan de coussin pour un plan de couchage plus long de 16 cm. Plan de couchage avec sommier électro soudé et sangles élastiques.

Matelas en mousse D25 indéformable revêtu en tissu stretch matelassé 100% polyester, h 11 cm.

1

composizione / arrangement / composition:

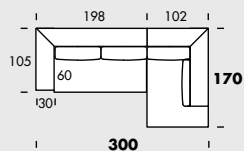

Laterale 3 posti large fisso DX-SX + Chaise Longue Midi DX-SX
RH-LH 3-seater large side element + RH-LH Midi chaise longue
Canapé bâtarde 3 places large D-G + Méridienne midi D-G

2

composizione / arrangement / composition:

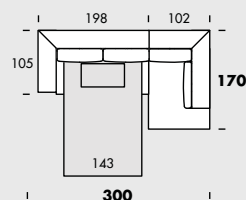

Laterale 3 posti large letto DX-SX + Chaise Longue Midi DX-SX
RH-LH 3-seater large side element bed + RH-LH Midi chaise longue
Canapé bâtarde convertible 3 places large D-G + Méridienne midi D-G

3

composizione / arrangement / composition:

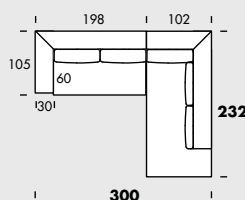

Laterale 3 posti large fisso DX-SX + Terminale Midi DX-SX
RH-LH 3-seater large side element + RH-LH Midi end element
Canapé bâtarde 3 places large D-G + Terminal midi D-G

4

composizione / arrangement / composition:

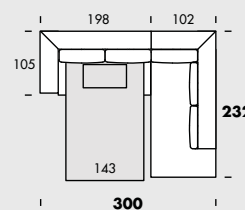

Laterale 3 posti large letto DX-SX + Terminale Midi DX-SX
RH-LH 3-seater large side element bed + RH-LH Midi end element
Canapé bâtarde convertible 3 places large D-G + Terminal midi D-G

5

composizione / arrangement / composition:

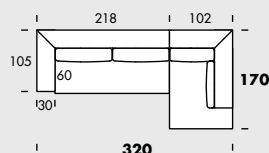

Laterale 3 posti maxi fisso DX-SX + Chaise Longue Midi DX-SX
RH-LH 3-seater maxi side element + RH-LH Midi chaise longue
Canapé bâtarde 3 places maxi D-G + Méridienne midi D-G

6

composizione / arrangement / composition:

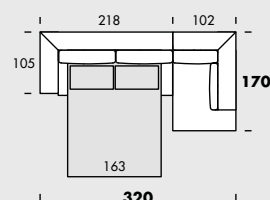

Laterale 3 posti maxi letto DX-SX + Chaise Longue Midi DX-SX
RH-LH 3-seater maxi side element bed + RH-LH Midi chaise longue
Canapé bâtarde convertible 3 places maxi D-G + Méridienne midi D-G

7

composizione / arrangement / composition:

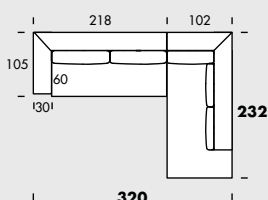

Laterale 3 posti maxi fisso DX-SX + Terminale Midi DX-SX
RH-LH 3-seater maxi side element + RH-LH Midi end element
Canapé bâtarde 3 places maxi D-G + Terminal midi D-G

8

composizione / arrangement / composition:

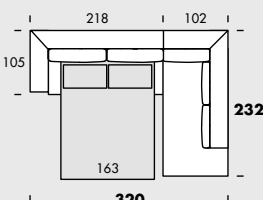

Laterale 3 posti maxi letto DX-SX + Terminale Midi DX-SX
RH-LH 3-seater maxi side element bed + RH-LH Midi end element
Canapé bâtarde convertible 3 places maxi D-G + Terminal midi D-G